



Genesis Process Technologies

Committed To Excellence



About us

In the year 2015 **GENESIS PROCESS TECHNOLOGIES** was established with a vision to become a quality supplier and solution provider for process machineries catering to Pharmaceutical, Nutraceutical, Food and Chemical industry.

In our wide range from the smallest lab scale units to large production units required for Granulation, Drying, Milling & Blending; we ensure high quality standards for products and services.

Genesis is your reliable and competent partner for best technologies individually designed for your production process to a team which has experience of more than 25 years in the pharma industry.

www.genesis-process.com

Duct Washing System Introduction

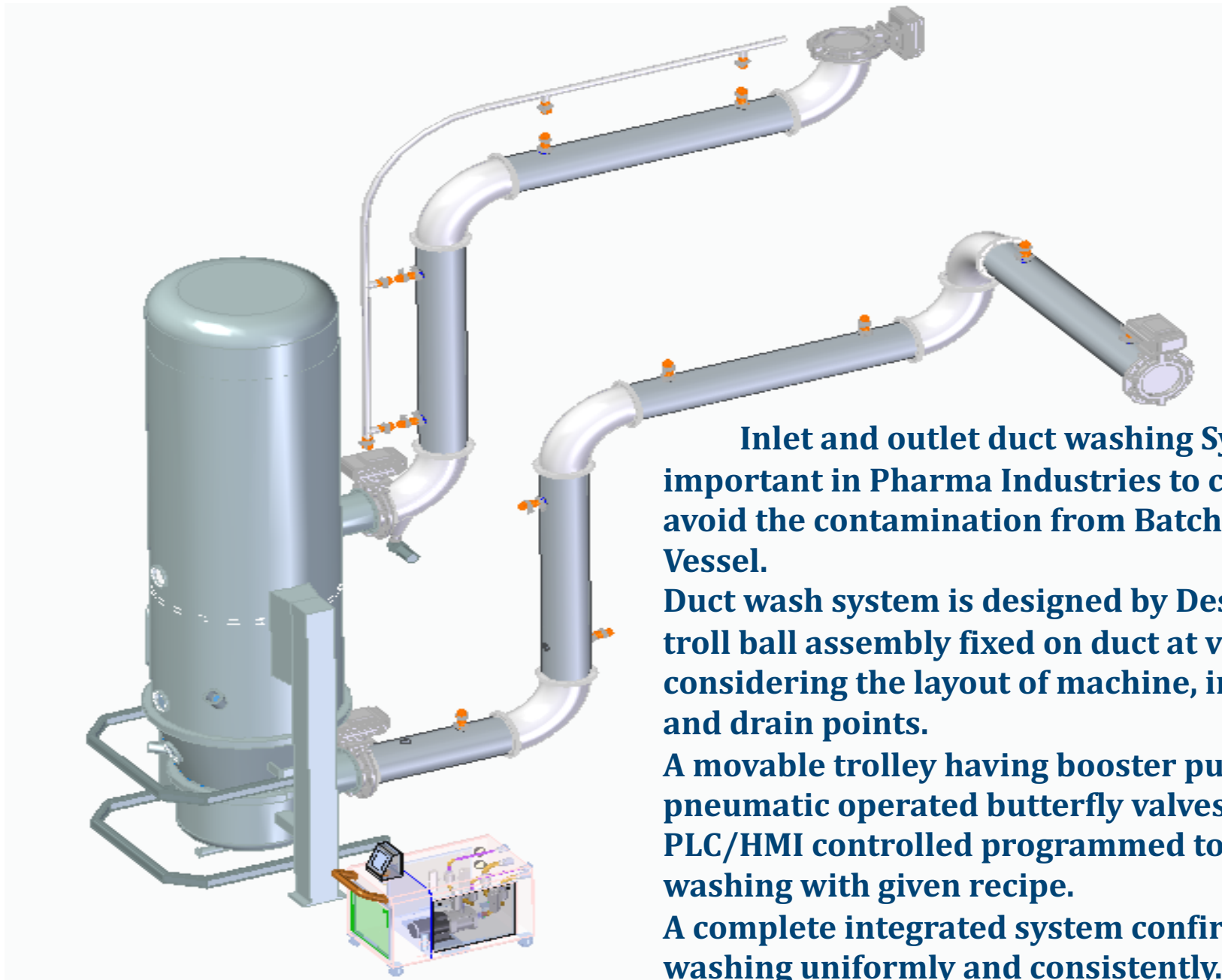

Inlet and outlet duct washing System is important in Pharma Industries to clean the duct and avoid the contamination from Batch to batch in single Vessel.

Duct wash system is designed by Designing special trolley ball assembly fixed on duct at various locations considering the layout of machine, including bends and drain points.

A movable trolley having booster pump and pneumatic operated butterfly valves, fully automatic PLC/HMI controlled programmed to complete washing with given recipe.

A complete integrated system confirms the duct washing uniformly and consistently.

Schematic Design of Duct washing System,

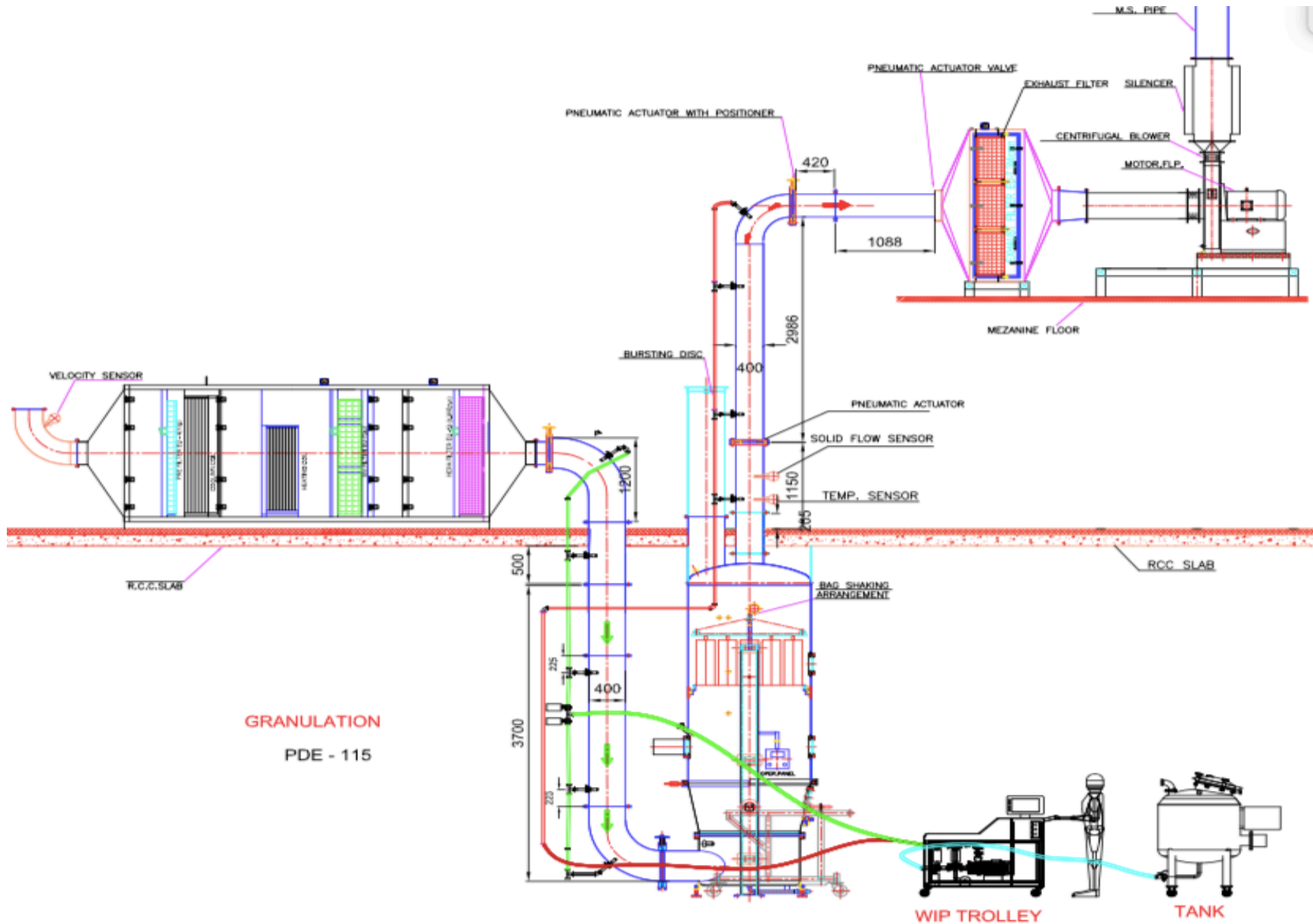

GRANULATION
PDE - 115

ABOUT SPRAY NOZLE MECHANISM

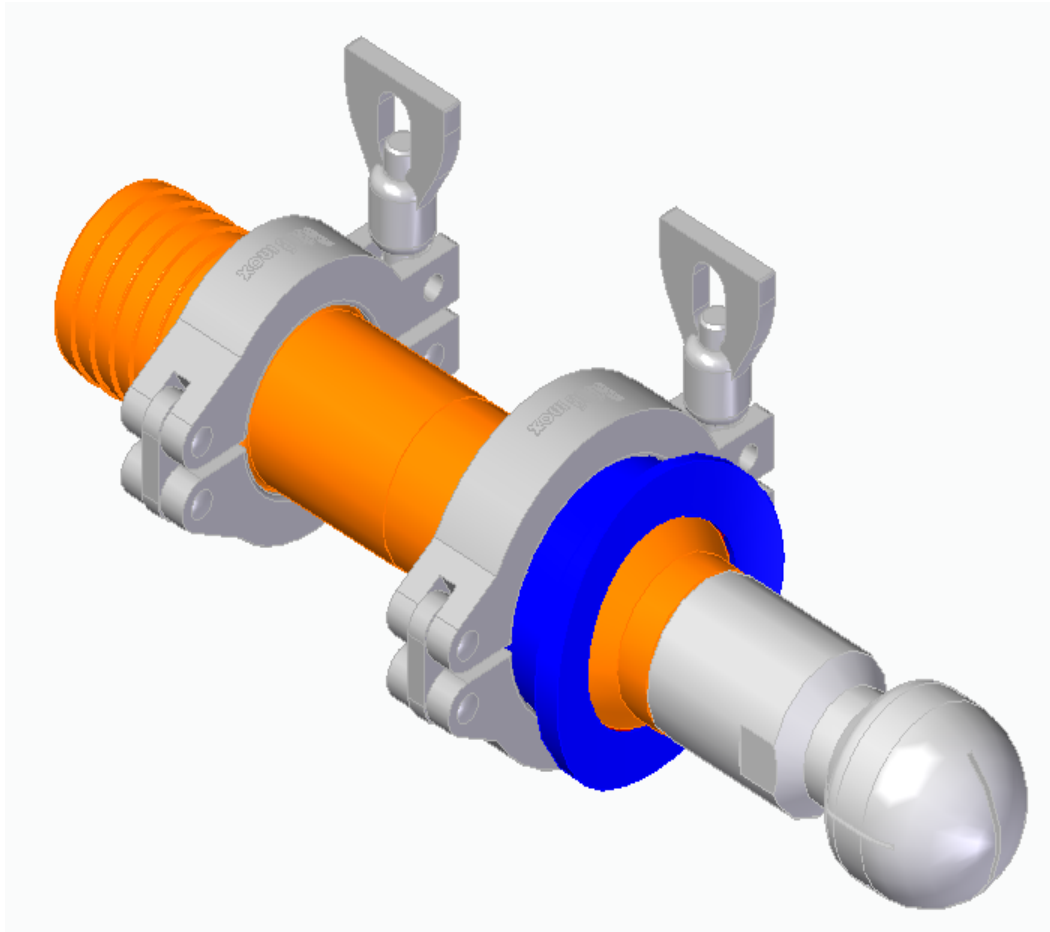

1. **Flush fitting adaptor welding on duct diameter.**
2. **Removable Tri-clover type troll ball assembly fixed against adaptor inside duct to ensure no leakage.**
3. **“O-ring” design ensure zero leakage and 12 bar explosion pressure testing.**
4. **Troll Ball:**
 - **FDA Approved**
 - 360 Deg Rotational
 - Make /Model: Lechler / 5MC.049
OR
 - Make /Model: Washmetic /
Sanispray / Roto SSC40
 - Mounting distance between 2 troll balls-1.5 Mtrs max.
 - Flow rate -24 LPM @ 2 Bar pressure
 - Washing covering radius-2 Mtrs @ 2 bar

ABOUT SPRAY NOZLE MECHANISM



Genesis Process Technologies

Committed To Excellence



ULTRA SANITARY, LOW FLOW, VARIABLE PRESSURE TANKWASHER

- **Slow Constant Rotation - Improved Cleaning Action**
- **No Bearings - No Maintenance, Longer Life**
- **Variable Pressure Input - Flexible & Versatile Operating Parameters.**
- **Compact Design - Ideal For Small Vessels/Pipes**
- **ATEX Exempt & FDA Approved - Regulatory Compliant**

Versatile & Unique

The "BTS" SANISPRAY is ideally suited for applications where a compact, low flow, high sanitary unit is required. The unique design offers flexible operating parameters from 2 bar to 20 bar, with flow rates from 24 l/min. The omission of bearings greatly increases the unit life and prohibits any contamination issues associated with bearing degradation. Additionally this unit offers ATEX exemption and FDA approved materials for a total regulatory compliant package.

Technical Data

Materials of Construction: Stainless Steel 316L

Max. Operating Temperature: 95° Centigrade

Max. Ambient Temperature: 140° Centigrade

**Standard Connections: 3/8" BSP/NPT Female, Pin Fix,
Weld Fix**

Nozzles Characteristics: 360° Spray Pattern

ABOUT SPRAY NOZLE MECHANISM

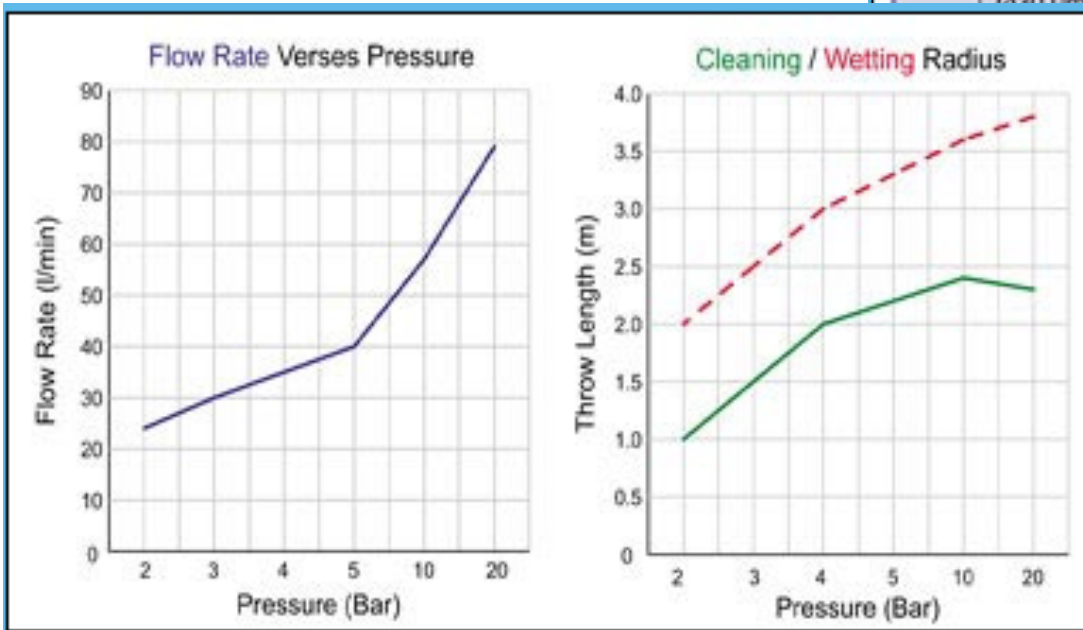
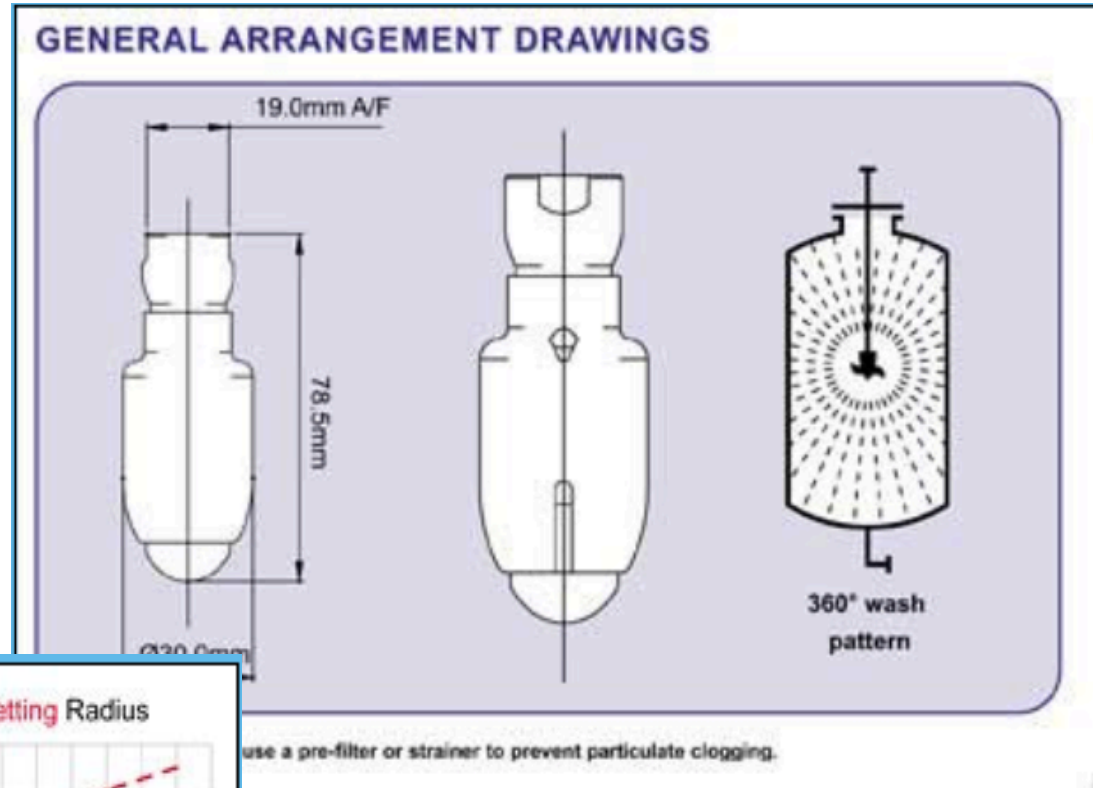

ABOUT SPRAY NOZLE MECHANISM

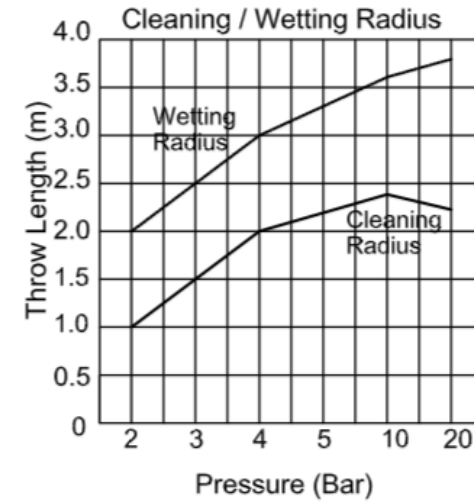
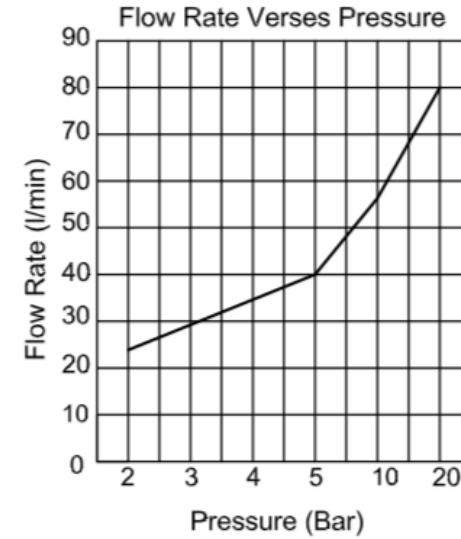
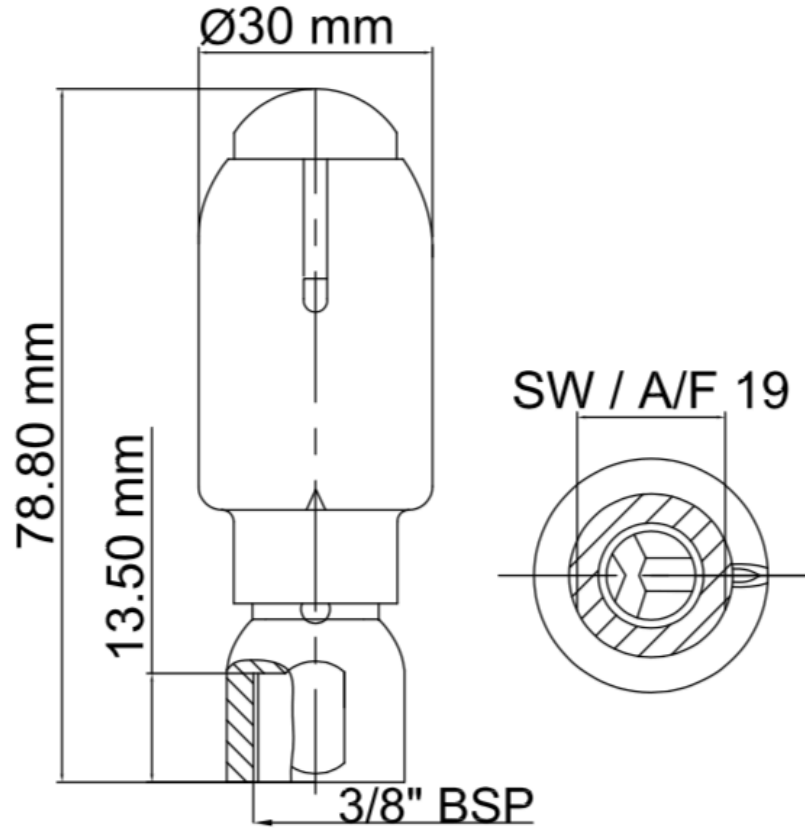

ABOUT SPRAY NOZLE MECHANISM



ABOUT SPRAY NOZLE MECHANISM



Materials
Stainless steel
316L SS,
Stainless steel
440C SS
Hastelloy C22,
Hastelloy C276

Max. temperature
140 °C

Recommended operating pressure
2 bar

Installation
Operation in every direction is possible

Filtration
Line strainer with a mesh size of 0.1 mm/170 Mesh

Bearing
Double ball bearing made of 440C SS
Double ball bearing made of C276

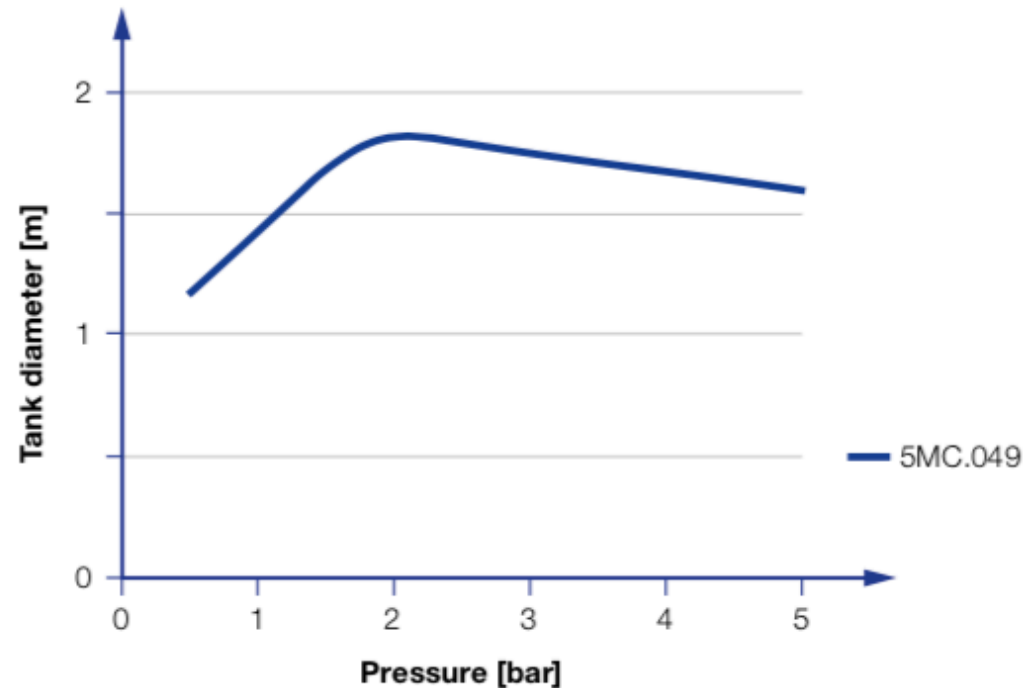

Overview of the tank diameter, depending upon the pressure of series 5MC

ABOUT WIP TROLLEY

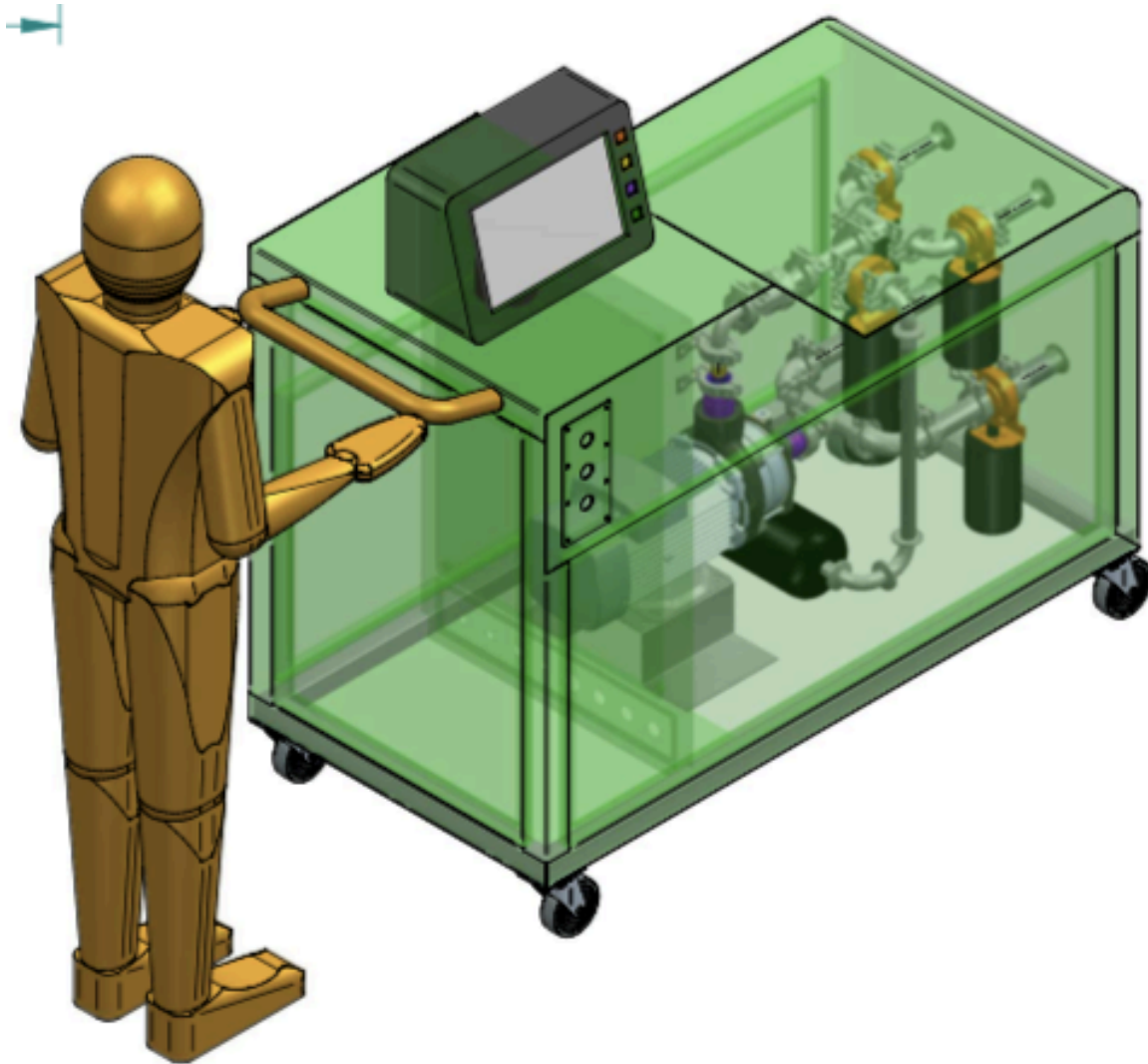

1. **Booster Pump**
 - Make:- Grundfos
 - IP55 protection

1. **2 Inlet Option of 1.5" TC size**
2. **2 Outlet Options for inlet and outlet**
Dust washing system.
3. **Compressed Air Provision with NRV at**
Outlet for water flushing.
4. **Complete SKID is made in SS304**
Material with enclosure
5. **Control System.**
 - a) **PLC - Mitsubishi**
 - FX5U - 32MR
 - Latest micro PLC
 - on board Ethernet port,
 - on board communication to VFDs

 - b) **HMI - Mitsubishi - GT2708,**
 - 8.4-inch color touch screen,
 - Power supply 24Vdc
 - 21cfr part 11 compliance,
 - direct printer connection.

 - c) **VFD - Mitsubishi**
 - 3 HP,400V,
 - Power supply 24Vdc
 - 21cfr part 11 compliance,
 - direct printer connection.

ABOUT WATER HEATING TANK

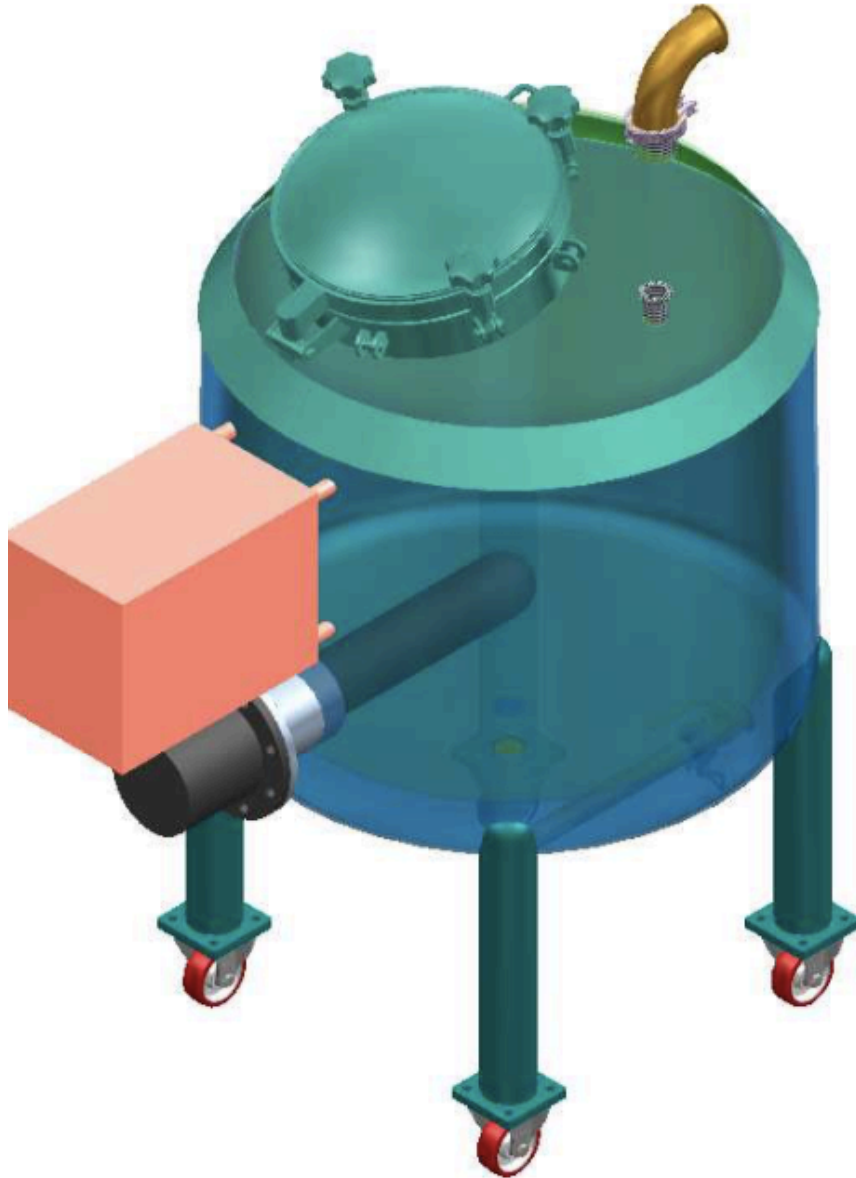

Standalone Water Heating Tank:

1. **Insulated Water Tank.**
2. **Gross Capacity-300 Ltr.**
3. **Electric Heater water immersed.**
4. **Inside SS304 /Mirror.**
5. **Outside SS304 /Matt.**
6. **Manual operated Butterfly vale at outlet size 1.5”.**
7. **Water level sensors to maintain the water level.**
8. **Standalone Control Panel mounted on Tank.**
9. **4 Legs with Castor wheels two swivel with break and two fixed type.**

SCHEMATIC DESIGN

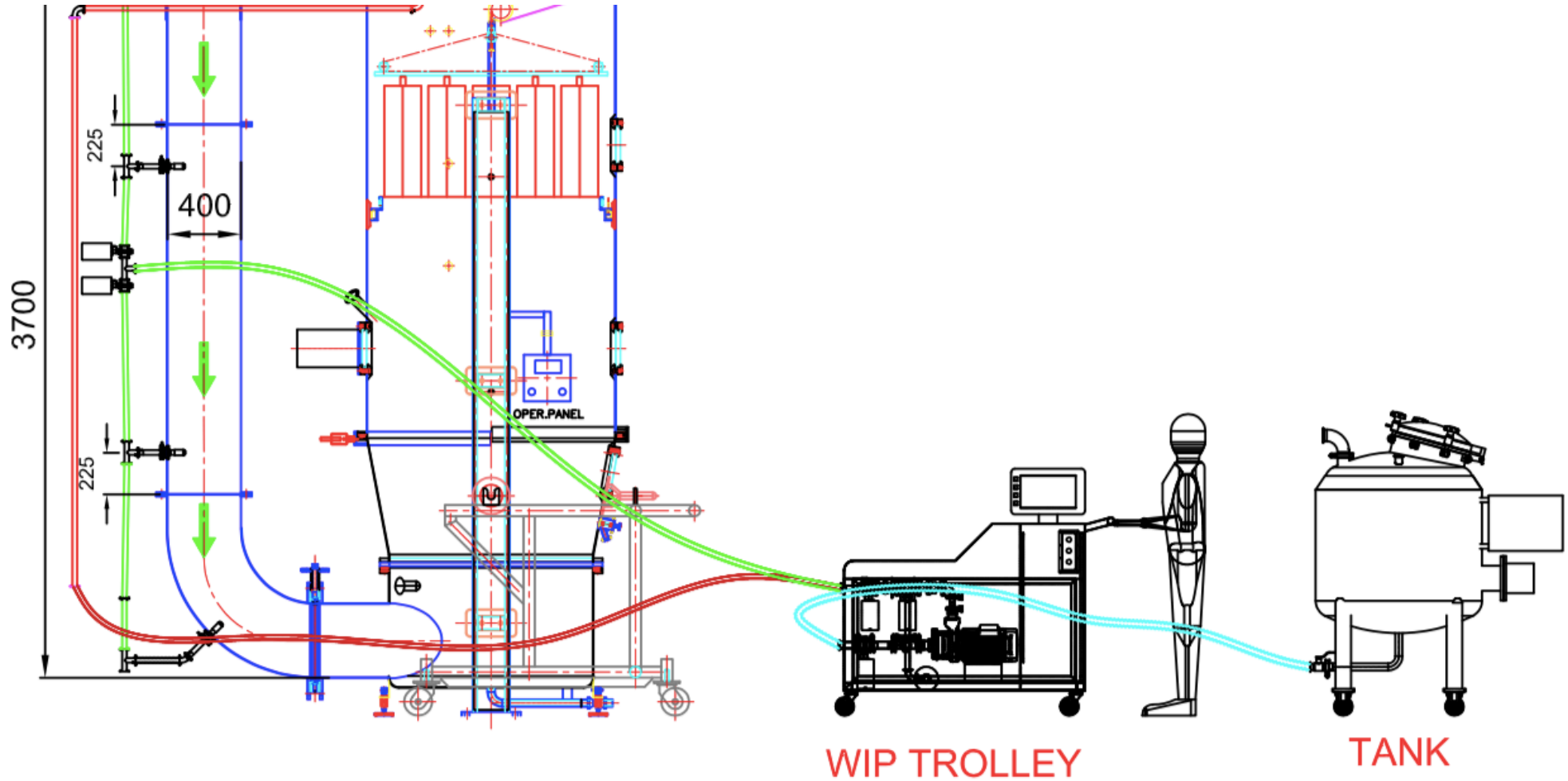

MENU SCREEN



MANUAL SCREEN

ALARM

MANUAL OPERATION

PREV

PARAMETER	IN LINE - 1 PRE-WASH	IN LINE - 1 FINAL-WASH	IN LINE - 2 RINSING	ACTUAL	Unit
EXHAUST STREAM - 1	456	456	456	456	Sec
EXHAUST STREAM - 2	456	456	456	456	Sec
INLET STREAM - 1	456	456	456	456	Sec
INLET STREAM - 2	456	456	456	456	Sec
INLET STREAM - 3	456	456	456	456	Sec
BOOSTER PUMP	456	456	456	456	%
OUTLET PRESS-SET	5.6	5.6	5.6	5.6	bar (g)
INLET TEMP-LO ALARM	56	56	56	456	°C

START PAUSE STOP MANUAL RESET WIP DRAIN ON COMP AIR ON

AUTO SCREEN

ALARM

RECIPE NAME: **AAAAAA** **AUTO**

PARAMETER	IN LINE - 1 PRE-WASH	IN LINE - 1 FINAL-WASH	IN LINE - 2 RINSING	ACTUAL	Unit
EXHAUST STREAM - 1	456	456	456	456	Sec
EXHAUST STREAM - 2	456	456	456	456	Sec
INLET STREAM - 1	456	456	456	456	Sec
INLET STREAM - 2	456	456	456	456	Sec
INLET STREAM - 3	456	456	456	456	Sec
BOOSTER PUMP	456	456	456	456	%
OUTLET PRESS-SET	5.6	5.6	5.6	5.6	bar (g)
INLET TEMP-LO ALARM	56	56	56	456	°C

START **PAUSE** **STOP** **MANUAL RESET** **WIP DRAIN ON** **COMP AIR ON**

RECIPE CREATE SCREEN



Genesis Process Technologies
Committed To Excellence

ALARM

RECIPE CREATE

NEXT

FEED THE RECIPE DATA AND GO TO NEXT PAGE

PARAMETER	IN LINE - 1 PRE-WASH	IN LINE - 1 FULL-WASH	IN LINE - 2 RINSING	Unit
EXHAUST STREAM - 1 - OFF	456	456	456	Sec
EXHAUST STREAM - 2 - OFF	456	456	456	Sec
INLET STREAM - 1 - OFF	456	456	456	Sec
INLET STREAM - 2 - OFF	456	456	456	Sec
INLET STREAM - 3 - OFF	456	456	456	Sec
BOOSTER PUMP	456	456	456	%
OUTLET PRESS-SET	5.6	5.6	5.6	bar (g)
INLET TEMP-LO ALARM	56	56	56	°C
COMP AIR OFF	BOOSTER PUMP MANUAL			

REPORTS SCREEN

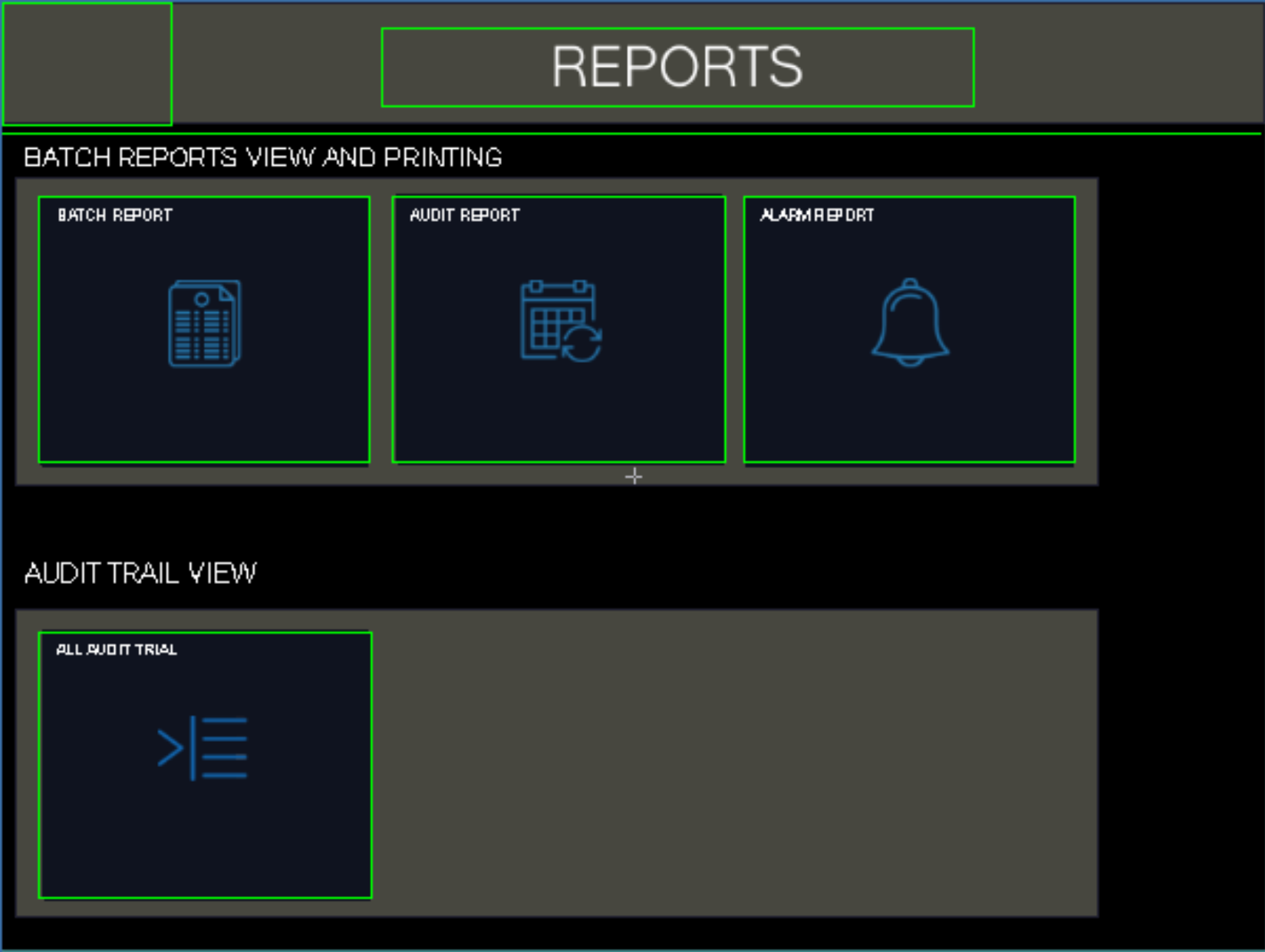

The screenshot displays a software interface for reports. At the top, a dark grey header contains the word "REPORTS" in white capital letters. Below this, the main content area is divided into two sections. The first section, titled "BATCH REPORTS VIEW AND PRINTING", contains three dark blue rectangular buttons. The first button is labeled "BATCH REPORT" and features a document icon. The second button is labeled "AUDIT REPORT" and features a calendar icon with a circular arrow. The third button is labeled "ALARM REPORT" and features a bell icon. A small white plus sign is centered below the "AUDIT REPORT" button. The second section, titled "AUDIT TRAIL VIEW", contains a single dark blue rectangular button labeled "ALL AUDIT TRAIL" with a right-pointing arrow and a list icon.

Thank You